

## FRU (Field Replaceable Unit) List

---

This chapter gives you the FRU (Field Replaceable Unit) listing in global configurations of LCD TV AT3201W. Refer to this chapter whenever ordering for parts to repair or for RMA (Return Merchandise Authorization).

Please note that WHEN ORDERING FRU PARTS, you should check the most up-to-date information available on your regional web or channel. For whatever reasons a part number change is made, it will not be noted on the printed Service Guide. For ACER AUTHORIZED SERVICE PROVIDERS, your Acer office may have a DIFFERENT part number code from those given in the FRU list of this printed Service Guide. You MUST use the local FRU list provided by your regional Acer office to order FRU parts for repair and service of customer machines.

**NOTE:** To scrap or to return the defective parts, you should follow the local government ordinance or regulations on how to dispose it properly, or follow the rules set by your regional Acer office on how to return it.

# Exploded Diagram

VL V131121020

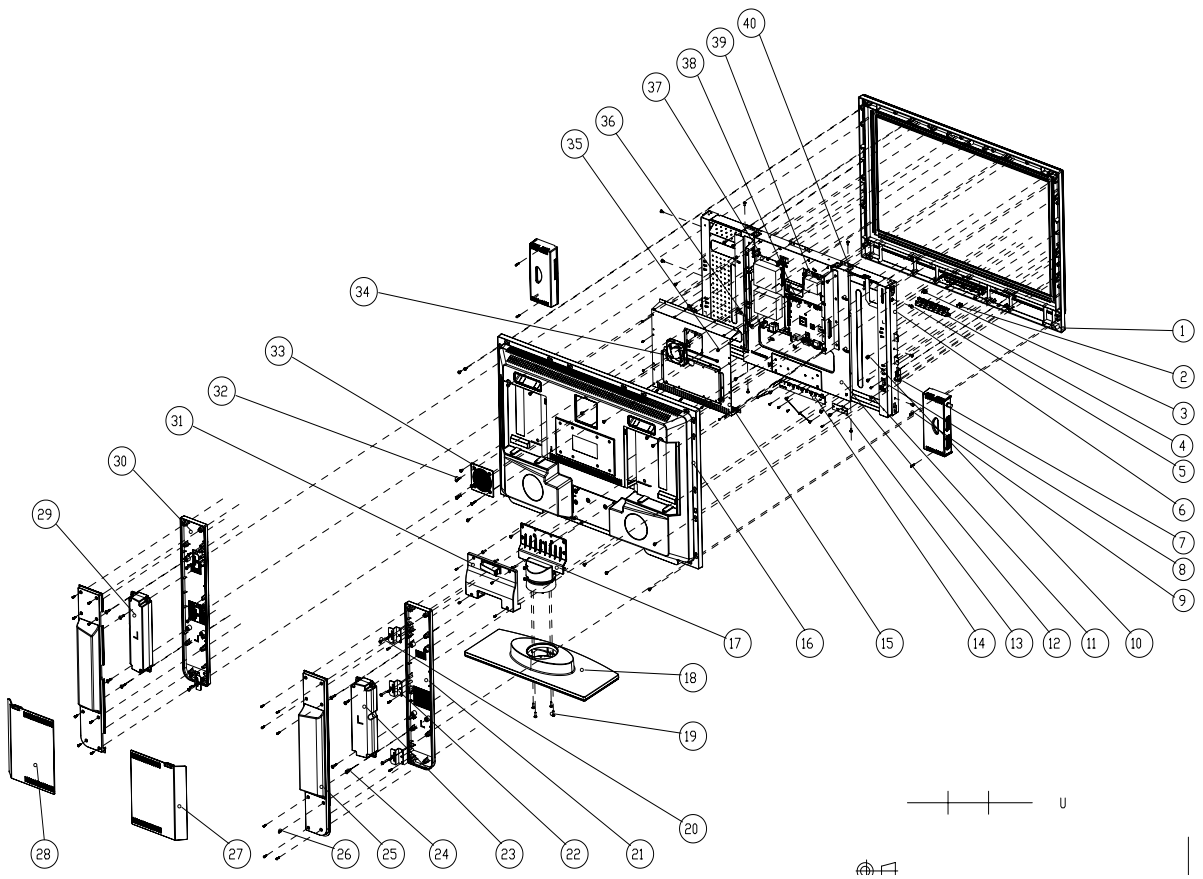

Number	Item
1	Front Cover Assy
2	IR Lens
3	Power Lens
4	Button Key
5	SCREW M4*10-B (BNI)
6	LCD BRACKET
7	SPEAKER BOARD
8	SPEAKER BOARD BRACKET
9	SCREW M3*16 P(NI)
10	SCREW T4*12-B(BLACK)
11	SCREW T3*8-P(BLACK)
12	LCD CHASSIS-M
13	EERPHONE BOARD
14	BUTTON BOARD
15	WALL MOUNT
16	BACK COVER ASSY

Number	Item
17	SWIVEL ASSY
18	STAND BASE ASSY
19	SCREW M4*15-B (NI+WASHER+SPRING)
20	SCREW T4*25-B(BNI)
21	SPEAKER BOX FRONT COVER -L
22	SPEAKER BOARD BRACKET
23	SPEAKER ASSY - L
24	SCREW 3 X 20.4-B (NI)
25	SPEAKER BOX BACK COVER -L
26	SCREW T3*12-B(BNI)
27	REAR COVER - L
28	REAR COVER - R
29	SPEAKER ASSY - R
30	SPEAKER BOX FRONT COVER -R
31	HINGE COVER
32	VB5 SCREW M3*22-B (BNI)
33	Fan Cover
34	FAN 12V
35	SCREW M3*5-P-NI-+
36	SCREW M4*6 P (NI) S/P
37	ADP/PWR BOARD W/MYLAR
38	MAINBOARD
39	AUDIO BOARD
40	LCD TFT AU 31.5 IN. T315XW01 V0

# FRU List

## AT3201W FRU List

Picture	No.	Partname And Description	Part Number
Accessory			
		REMOTE CONTROL 80-10185 (EU)	25.M01V7.001
Boards			
		IO BOX MODULE	6M.M03V7.001
		TUNER MODULE - PAL	6M.M03V7.002
		ADP/PWR BOARD W/MYLAR	55.M03V7.001
		MAINBOARD	55.M03V7.002
		AUDIO BOARD	55.M03V7.002
		BUTTON BOARD	55.M03V7.004
		EERPHONE BOARD	55.M03V7.005
		INTERFACE BOARD	55.M03V7.006

## AT3201W FRU List

Picture	No.	Partname And Description	Part Number
		SPEAKER BOARD	55.M03V7.007
Case/Cover/Bracket Assembly			
		SWIVEL ASSY	60.M03V7.001
		STAND BASE ASSY	60.M03V7.002
		HINGE COVER	42.M03V7.001
		REAR COVER - R	42.M03V7.002
		REAR COVER - L	42.M03V7.003
		BACK COVER ASSY	60.M03V7.003
		FRONT COVER AASY	60.M03V7.004
		WALL MOUNT	33.M03V7.001
		SPEAKER BOX BACK COVER -R	42.M03V7.004

## AT3201W FRU List

Picture	No.	Partname And Description	Part Number
		SPEAKER BOX BACK COVER -L	42.M03V7.005
		SPEAKER BOX FRONT COVER -R	42.M03V7.006
		SPEAKER BOX FRONT COVER -L	42.M03V7.007
		SPEAKER BOX FRAME	33.M03V7.002
		SPEAKER BOARD BRACKET	33.M03V7.003
		LCD BRACKET	33.M03V7.004
		LCD CHASSIS-M	33.M03V7.005
		BUTTON KEY	42.M03V7.008
		FAN COVER	42.M03V7.009
		IR LENS	42.M03V7.010

## AT3201W FRU List

Picture	No.	Partname And Description	Part Number
		POWER LENS	42.M03V7.011
		WIRE SADDLE CHA-4	42.M03V7.012
		WIRE SADDLE MWS-7	42.M03V7.013
		GASKET STICK	47.M03V7.001
<b>Cables</b>			
		POWER CODE ITALY 3P 1.8M	27.M03V7.001
		POWER CODE EU 3P 1.8M	27.M03V7.002
		POWER CODE UK 3P 1.8M	27.M03V7.003
		CABLE- MB TO AUDIO	50.M03V7.001
		CABLE- MB TO POWER	50.M03V7.002
		CABLE- EARPHONE	50.M03V7.003

## AT3201W FRU List

Picture	No.	Partname And Description	Part Number
		CABLE- AUDIO TO POWER	50.M03V7.004
		CABLE- SWITCH CABLE	50.M03V7.005
		CABLE- BUTTON	50.M03V7.006
		CABLE- LINE OUT	50.M03V7.007
		CABLE- AV3	50.M03V7.008
		CABLE- BTM TO EARPHONE	50.M03V7.009
		CABLE- EMI GROUND	50.M03V7.010
		CABLE- FAN TO POWER	50.M03V7.011
		CABLE- SPEAKER - R	50.M03V7.012
		CABLE- SPEAKER - L	50.M03V7.013



## AT3201W FRU List

Picture	No.	Partname And Description	Part Number
		CABLE- INVERTER	50.M03V7.014
		CABLE- VGA 1.8M BLACK	50.M03V7.015
		CABLE- MB TO LCD	50.M03V7.016
		CABLE- RCA RGB 1.8M BLACK	50.M03V7.017
		CABLE- VB1D PAL 1.8M BLACK	50.M03V7.018
		CABLE- SCART BLSAK	50.M03V7.019
		CABLE- RCA YWR 1.8M BLACK	50.M03V7.020
		CABLE- S LINE 1.8M BLACK	50.M03V7.021
LCD			
		LCD TFT AU 31.5 IN. T315XW01 V0	56.M03V7.001
Miscellaneous			
		PE BAG FOR PANEL	47.M03V7.001

## AT3201W FRU List

Picture	No.	Partname And Description	Part Number
		PANEL CONTACT PAD	47.M03V7.002
Fan			
		FAN 12V	23.M03V7.001
Speaker			
		SPEAKER ASSY - R	23.M03V7.002
		SPEAKER ASSY - L	23.M03V7.003
Screws			
		SCREW M3*5-P-NI+	86.M01V7.001
		SCREW 4-40 UNC P-NI	86.M01V7.009
		SCREW M3*16 P(NI)	86.M01V7.010
		VB5 SCREW M3*22-B (BNI)	86.M03V7.001
		SCREW M4*10-B (BNI)	86.M03V7.002

**AT3201W FRU List**

Picture	No.	Partname And Description	Part Number
		SCREW T3*8-P(BLACK)	86.M03V7.003
		SCREW T4*12-B(BLACK)	86.M03V7.004
		SCREW T4*25-B(BNI)	86.M03V7.005
		SCREW M4*15-B (NI+WASHER+SPRING)	86.M03V7.006
		SCREW 3 X 20.4-B (NI)	86.M03V7.007
		SCREW M4*6 P (NI) S/P	86.M03V7.008